

**INFORMATION ONLY**

# PRELIMINARY APPROVED SITE PLAN

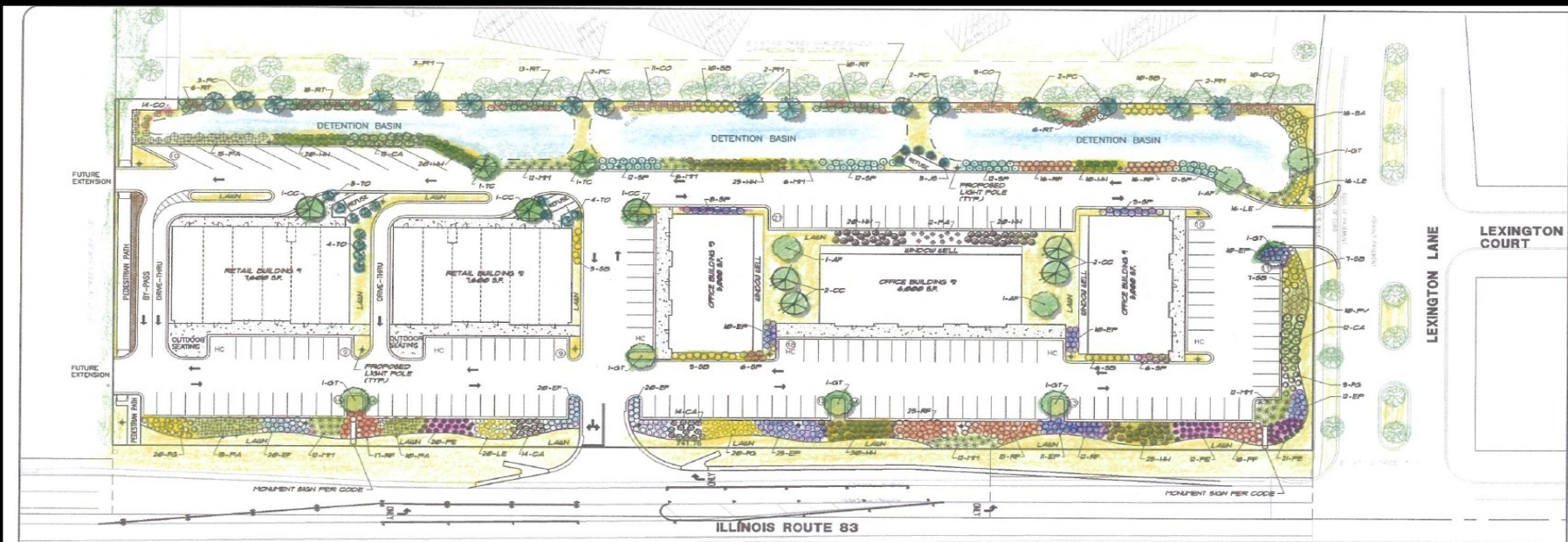

DATE	DESCRIPTION	DRAWN BY

**IC CONSULTING, INC.**  
 INFRASTRUCTURE & GEOTECH  
 CONSULTING CIVIL ENGINEERS, PLANNERS & LAND SURVEYORS  
 300 WINDYBROOK PARK, WINDYBROOK, ILLINOIS 60090  
 TEL: (847) 251-1111 FAX: (847) 251-1177  
**LANDSCAPE & LIGHTING PLAN**  
 DATE: 11/28/07  
 SCALE: 1"=30'

**PROPOSED COMMERCIAL DEVELOPMENT**  
 ILLINOIS ROUTE 83/LEXINGTON LANE  
 GRAYS LAKE, ILLINOIS

PROJECT No.  
 6008  
 1 of 1

**SITE DATA:**  
 GROSS SITE AREA 5108 AC.  
 LESS ROW 0709 AC.  
 NET SITE AREA 4399 AC.  
 PROPOSED USES:  
 1) RETAIL - 15,200 SQ. FT.  
 2) OFFICE (3 BUILDING) - 16,200 SQ. FT.  
 TOTAL - 31,400 SQ. FT.

- LEGEND**
- EXISTING TREE
  - 6" DECORATIVE LIGHT STANDARD PER VILLAGE'S CORRIDOR STREETScape ENHANCEMENT CRITERIA
  - 6" HIGH SHADOWBOX CEDAR FENCE SEGMENTS
  - BOTANICAL NAME: SCHIZANTHUS PUPURUS 'RUBY STAR'
  - HEMEROCALLIS 'HAPPY RETURNS'
  - DELICANTHUS 'P' SUPERBUNT WHITE DREAM'
  - FRYOPSIS A. TROPICPOLIA 'LONGIN'
  - REDROCKA BLEND 'VIA BALTHAZAR'
  - BYCNTHUS FORTUNEI 'COLORATUS'
  - COYON NAME: WEST STAR PURPLE CONIFLOVER
  - HAPPY RETURNS DAYLILY
  - WHITE DREAM SAISTA DAISY
  - LONGIN RUSSIAN SAGE
  - GOLDENROD ORANGE CONIFLOVER
  - PURPLE LEAF SINTERCREEPER
  - COYON NAME: FALL BLOOMING FEATHER REED GRASS
  - TORNADO LIGHT JAPANESE SILVER GRASS
  - FOUNTAIN GRASS
  - RED FOUNTAIN GRASS
  - EARLY BLOOMING BLACK FOUNTAIN GRASS

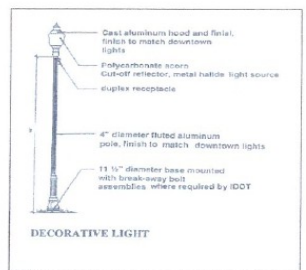

PROPOSED RETAIL BLDG. 1 FRONT ELEVATION (BLDG. 2 OPP.)



PROPOSED RETAIL BLDG. 1 SIDE ELEVATIONS (BLDG. 2 SIM.)

**BLUE CHIP**  
 Commercial Real Estate, LLC.  
 Development | Investments | Brokerage

**Tim Billmack**  
 Managing Broker  
 815.355.0196  
 billmackt@gmail.com

Disclaimer: Blue Chip Commercial Real Estate, LLC is the owner's designated agent and makes no warranties or representations as to the accuracy or completeness of this information contained herein. The information has been obtained through sources deemed reliable; however, it is up to the purchaser to conduct due diligence prior to sale or lease.