

RESIDENTIAL  
ALTA-LAND TITLE  
TOPOGRAPHIC  
CONDOMINIUM  
SUBDIVISION  
CONSTRUCTION

# Plat of Survey

R. E. DECKER  
(1933-1999)  
R. G. PAVLETIC  
F. T. DECKER

R. E. DECKER, P.C.  
PROFESSIONAL LAND SURVEYORS  
114 E. COOK AVE., LIBERTYVILLE, ILLINOIS 60048  
847-362-0091 FAX 847-362-0119 E-mail decker2157@aol.com

BOOK 00 PAGE 1438 ORDER NO. 00-1438 LIBERTYVILLE, JULY 27 2000

FOR BERO TO GAPINSKI  
ORDERED BY ANDREW LYNCH, ATTY.  
Lots 10 and 11 in Block 51 in Venetian Village Unit 4, being a Subdivision of part of the East 1/2 of Section 10, Township 45 North, Range 10, East of the Third Principal Meridian, according to the Plat thereof, recorded in the Records of Lake County, on August 19, 1946 as Document 597873 in Book 30 of Plats, Page 74, in Lake County, Illinois.  
Commonly known as: 36897 N NATHAN HALE DRIVE, LAKE VILLA, ILLINOIS.



Scale, 1" = 20 ft.  
TOP OF PLAT IS NORTH

LIBERTYVILLE, JULY 27 2000  
STATE OF ILLINOIS } ss  
COUNTY OF LAKE }

LIBERTYVILLE, JULY 27 2000  
STATE OF ILLINOIS } ss  
COUNTY OF LAKE }

We hereby certify that the buildings on lot shown are within property lines and that the adjoining improvements do not encroach on said premises.

R. E. DECKER, P.C.

By: [Signature]  
Professional Land Surveyor

This is to certify that we have surveyed the above described property and have prepared the plat hereon drawn. The legal description shown hereon is provided by others. Refer to Title, Covenants or Building Department for additional Easements, Setbacks or other Restrictions which may exist. We shall not be responsible for any construction unless all property stakes are shown on this Plat. Dimensions not noted hereon shall not be assumed by scaling or otherwise.

R. E. DECKER, P.C.

By: [Signature]  
Professional Land Surveyor

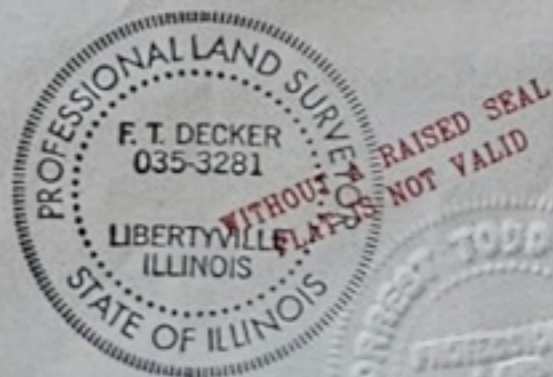

Compare the Description on this Plat with your Deed and Title; also compare all stakes to this Plat before building by them, and report any differences at once. Dimensions are shown in feet and decimal parts thereof.